

let's get started

This is an easy-to-use test kit for home-use designed to detect gluten fragments in **stool** samples. Use Gluten Detective on a regular basis to monitor total gluten consumption (50+ mg = crumb of bread) over the previous 1-7 days. The test is quick and convenient, providing results in less than 25 minutes.



results in
less than
25 mins

your **stool** kit includes:



collect your sample

- 1 Pull apart the ends of the **stool collector**, exposing the adhesive. Secure the collector to the rim of the toilet using the two sticky sides.
- 2 Deposit the **stool sample** on the collection paper. **NOTE:** do not allow the stool sample to contact the toilet water until after the sample has been collected.
- 3 Open the **extraction solution** (red cap) and use the **collection stick** to fill the spoon with stool from three different sites of the sample until the sample touches the solution.
- 4 Gently stir the **collection stick** into the **extraction solution** (red cap). Close the cap tightly.
- 5 Shake the **extraction solution tube** (red cap) containing the sample intermittently over a 10 minute period (for example shake 1 minute, rest 1-2 minutes and etc.) until the sample appears fully liquid.



process your test

- 6 Let the sample stand for **2 minutes**.
- 7 Unscrew the clear cover of the **extraction solution tube** (red cap) and carefully add 10 drops into the **dilution solution** (blue cap). Close the cap tightly.
- 8 Mix the **dilution solution tube** (blue cap) softly for at least **15 seconds**.
- 9 Open the foil pouch containing the detection **test strip** and the **plastic dropper** - place on a flat surface.
- 10 With the **dropper** add 8 drops from the **dilution solution tube** (blue cap) to the "S" zone on the **test strip**.

Let stand for 10 minutes.

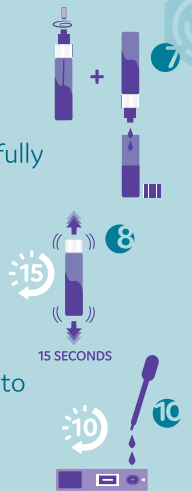

read the results



(+) positive

positive: Two lines appear; a green line in the control zone (C) and a red line in the test zone (T) means that **there was gluten intake within the last 1 - 7 days**.



(-) negative

negative: A single green line appears in the control zone (C). If the green line does not appear, the result of the test is considered invalid, even if the red line appears in the test zone (T).



invalid

invalid: In the case of invalid results, it is necessary to repeat with a new test following the correct procedure. If the problem persists, please contact Gluten Detective.



!instructions

Please read all instructions completely before attempting to perform this test.



order at glutendetective.com

Check if you've accidentally consumed gluten **in the past day**.
Test as needed with this **urine** kit.

Try our **urine** kit when you suspect symptoms.
Want to detect more recent gluten?

Suspect.
Test.
Verify.



urine

open
me!

Monitor your total gluten consumption **over previous days**.
Conduct regular check-ins with this **stool** kit.